



# WARRIOR UPDATE

ISSUE No.5 August 2010

Round Rock Independent School District

Westwood High School Master Plan News

Campus Vehicular Traffic Routes

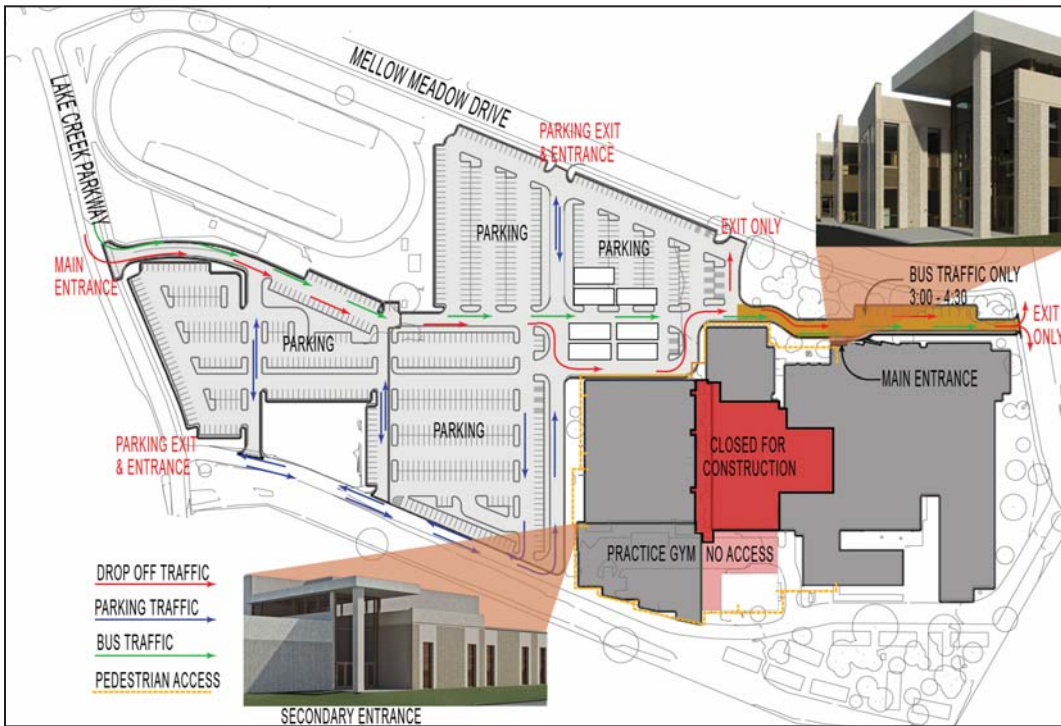

Campus Pedestrian Routes



The 2010-2011 school year begins with some changes on the WHS campus resulting from completed construction of the new gym and central plant and construction inside the building begun over the summer. The plans here show the new vehicular traffic routes for campus and the allowed student/pedestrian routes in and around the buildings due to ongoing construction.

Routes and access to parts of the building will change throughout the school year. Signs will be posted to direct students, staff and visitors to the acceptable routes and areas of the building. To ensure the safest learning and working environment, please follow all construction signs.